

PART SECTION Y-Y

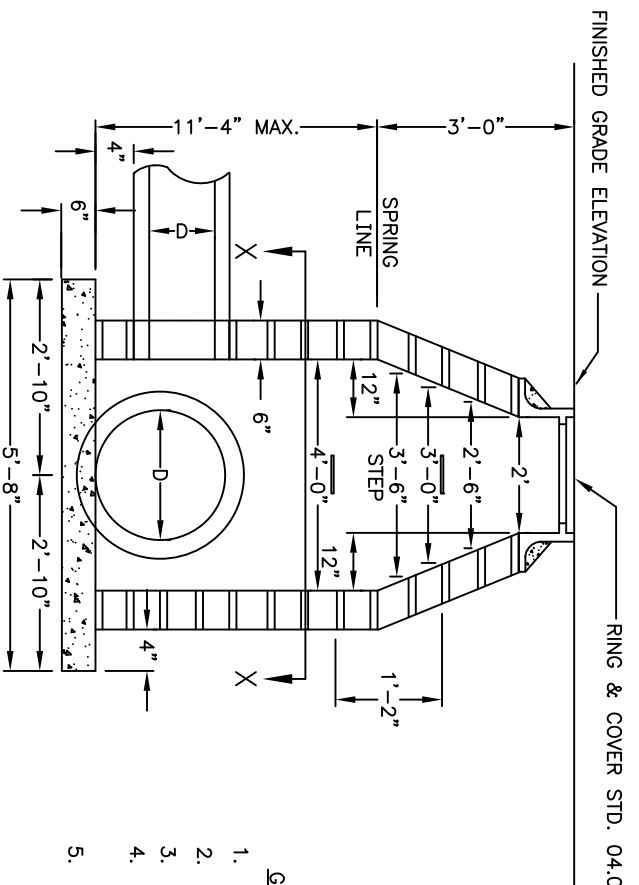

SECTION X-X

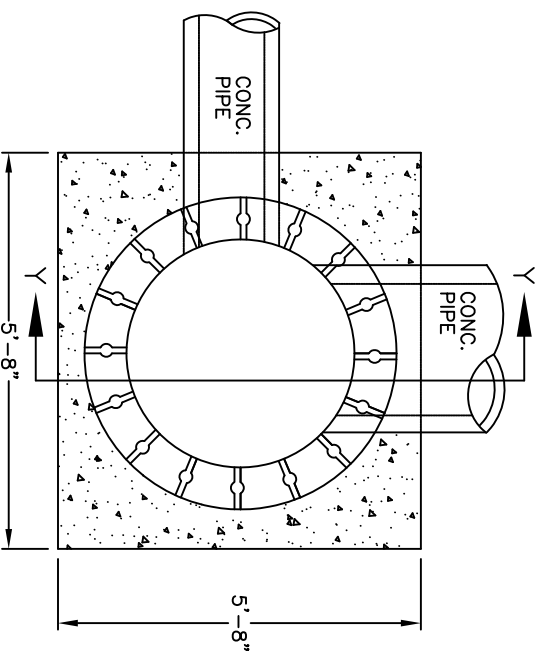

SECTION Y-Y

- GENERAL NOTES:**
1. ALL MORTAR JOINTS TO BE 1/2" (+/-) 1/8"
 2. ALL EXPOSED JOINTS WILL BE CONCAVE TOOLED.
 3. ALL SLABS SHALL BE FORMED.
 4. ALL CONCRETE TO BE 3600 P.S.I. COMPRESSIVE STRENGTH.
 5. ALL PIPE IN STORM DRAIN STRUCTURES SHALL BE STRUCK EVEN WITH THE INSIDE WALL, GROUTED AND BRUSHED SMOOTH.
 6. MANHOLES OVER 3'-6" IN DEPTH SHALL BE PROVIDED WITH STEPS 1'-2" ON CENTERS BEGINNING 1'-2" FROM THE BOTTOM OF THE CATCH BASIN.
 7. FOR RING AND COVER SEE DETAIL 04.02.04. ②

REVISIONS		
NO.	DATE	DESCRIPTION
1	05/2008	REV NOTE 6 & 7 REM #8
2	01/2015	ADD DETAIL NO. TO NOTE



BLOCK MANHOLE
15" THRU 36" PIPE

CITY OF MONROE NORTH CAROLINA		FILE: I:\Maps-Details\Detail Manual\Details	
ENGINEERING DEPARTMENT		DRAWN BY: JAM	DATE: 08-07-01
		CHECKED BY: JNL	SCALE: N.T.S.
		DETAIL 04.01.09	