

SITE AND DEVELOPMENT DATA	
JURISDICTION	MONROE, NC
TAX PARCEL(S)	08/01/12-08/02/12
SITE ADDRESS	2 PACELAND WAY
CURRENT ZONING	RLD (MONROE, RA-40/UNION COUNTY)
PROPOSED ZONING	PUD "EAGLES REST AT LAKE LEE"
USE CLASSIFICATION	COMMERCIAL/RESIDENTIAL
LOTS PROPOSED	670 UNITS
TOTAL AREA	340.31 AC.
PROPOSED RIGHT-OF-WAY	39.48 AC (11.59%)
STREAM BUFFER	19.15 AC (5.62%) NOTE: BUFFERS ARE 50' FROM TOP OF BANK
EX. POWER ESMT.	1.02 AC (TO BE ABANDONED AFTER CONSTRUCTION)
NET PROJECT AREA	280.88 AC
DENSITY	2.39 DUNIT/ACRE
AREA IN LOTS	121.90 AC
COMMON AREA TOTAL	158.05 AC-43.8% (118+ ACRES COS, 21 AC+ EAGLE'S REST PARK)
COMMON AREA (IN FLOOD PLAIN)	2.4 AC (DAM REGULATED) 1.7% COS
COMMON AREA (IN PONDS)	12 AC (APPROXIMATE) 8.63% COS
COMMERCIAL (GB)	16.91 AC (4.87%)
GB BUILDING SETBACKS	
MINIMUM FRONT	20'
MINIMUM REAR	10'
MAX. HEIGHT WITHIN PUD	3 STORIES
RESIDENTIAL BUILDING SETBACKS (ALL TYPES)	
MINIMUM FRONT	20'
MINIMUM CORNER/SIDE	10/10'
MINIMUM REAR	20'
MINIMUM LOT SIZE	5,500
60' LOTS	365
50' LOTS	305
55 & OLDER COMMUNITY	531
65 & OLDER COMMUNITY	139
TREE SAVE AREA:	48.6 AC 14.27% (20.7 EAGLE REST PARK, 19.15 WITHIN STREAM BUFFERS, 6.7 ACRES WITHIN 100' UNDISTURBED BUFFERS)

1. BUFFER NOTES: BUFFERS TO MEET OR EXCEED MONROE STANDARDS IN SECTION 8.3.5 OF UDO
2. BUFFER ALONG LAKE LEE: PROPERTIES 101, 102, 103, 104, 105, 106, 107, 108, 109, 110, 111, 112, 113, 114, 115, 116, 117, 118, 119, 120, 121, 122, 123, 124, 125, 126, 127, 128, 129, 130, 131, 132, 133, 134, 135, 136, 137, 138, 139, 140, 141, 142, 143, 144, 145, 146, 147, 148, 149, 150, 151, 152, 153, 154, 155, 156, 157, 158, 159, 160, 161, 162, 163, 164, 165, 166, 167, 168, 169, 170, 171, 172, 173, 174, 175, 176, 177, 178, 179, 180, 181, 182, 183, 184, 185, 186, 187, 188, 189, 190, 191, 192, 193, 194, 195, 196, 197, 198, 199, 200, 201, 202, 203, 204, 205, 206, 207, 208, 209, 210, 211, 212, 213, 214, 215, 216, 217, 218, 219, 220, 221, 222, 223, 224, 225, 226, 227, 228, 229, 230, 231, 232, 233, 234, 235, 236, 237, 238, 239, 240, 241, 242, 243, 244, 245, 246, 247, 248, 249, 250, 251, 252, 253, 254, 255, 256, 257, 258, 259, 260, 261, 262, 263, 264, 265, 266, 267, 268, 269, 270, 271, 272, 273, 274, 275, 276, 277, 278, 279, 280, 281, 282, 283, 284, 285, 286, 287, 288, 289, 290, 291, 292, 293, 294, 295, 296, 297, 298, 299, 300, 301, 302, 303, 304, 305, 306, 307, 308, 309, 310, 311, 312, 313, 314, 315, 316, 317, 318, 319, 320, 321, 322, 323, 324, 325, 326, 327, 328, 329, 330, 331, 332, 333, 334, 335, 336, 337, 338, 339, 340, 341, 342, 343, 344, 345, 346, 347, 348, 349, 350, 351, 352, 353, 354, 355, 356, 357, 358, 359, 360, 361, 362, 363, 364, 365, 366, 367, 368, 369, 370, 371, 372, 373, 374, 375, 376, 377, 378, 379, 380, 381, 382, 383, 384, 385, 386, 387, 388, 389, 390, 391, 392, 393, 394, 395, 396, 397, 398, 399, 400, 401, 402, 403, 404, 405, 406, 407, 408, 409, 410, 411, 412, 413, 414, 415, 416, 417, 418, 419, 420, 421, 422, 423, 424, 425, 426, 427, 428, 429, 430, 431, 432, 433, 434, 435, 436, 437, 438, 439, 440, 441, 442, 443, 444, 445, 446, 447, 448, 449, 450, 451, 452, 453, 454, 455, 456, 457, 458, 459, 460, 461, 462, 463, 464, 465, 466, 467, 468, 469, 470, 471, 472, 473, 474, 475, 476, 477, 478, 479, 480, 481, 482, 483, 484, 485, 486, 487, 488, 489, 490, 491, 492, 493, 494, 495, 496, 497, 498, 499, 500, 501, 502, 503, 504, 505, 506, 507, 508, 509, 510, 511, 512, 513, 514, 515, 516, 517, 518, 519, 520, 521, 522, 523, 524, 525, 526, 527, 528, 529, 530, 531, 532, 533, 534, 535, 536, 537, 538, 539, 540, 541, 542, 543, 544, 545, 546, 547, 548, 549, 550, 551, 552, 553, 554, 555, 556, 557, 558, 559, 560, 561, 562, 563, 564, 565, 566, 567, 568, 569, 570, 571, 572, 573, 574, 575, 576, 577, 578, 579, 580, 581, 582, 583, 584, 585, 586, 587, 588, 589, 590, 591, 592, 593, 594, 595, 596, 597, 598, 599, 600, 601, 602, 603, 604, 605, 606, 607, 608, 609, 610, 611, 612, 613, 614, 615, 616, 617, 618, 619, 620, 621, 622, 623, 624, 625, 626, 627, 628, 629, 630, 631, 632, 633, 634, 635, 636, 637, 638, 639, 640, 641, 642, 643, 644, 645, 646, 647, 648, 649, 650, 651, 652, 653, 654, 655, 656, 657, 658, 659, 660, 661, 662, 663, 664, 665, 666, 667, 668, 669, 670, 671, 672, 673, 674, 675, 676, 677, 678, 679, 680, 681, 682, 683, 684, 685, 686, 687, 688, 689, 690, 691, 692, 693, 694, 695, 696, 697, 698, 699, 700, 701, 702, 703, 704, 705, 706, 707, 708, 709, 710, 711, 712, 713, 714, 715, 716, 717, 718, 719, 720, 721, 722, 723, 724, 725, 726, 727, 728, 729, 730, 731, 732, 733, 734, 735, 736, 737, 738, 739, 740, 741, 742, 743, 744, 745, 746, 747, 748, 749, 750, 751, 752, 753, 754, 755, 756, 757, 758, 759, 760, 761, 762, 763, 764, 765, 766, 767, 768, 769, 770, 771, 772, 773, 774, 775, 776, 777, 778, 779, 780, 781, 782, 783, 784, 785, 786, 787, 788, 789, 790, 791, 792, 793, 794, 795, 796, 797, 798, 799, 800, 801, 802, 803, 804, 805, 806, 807, 808, 809, 810, 811, 812, 813, 814, 815, 816, 817, 818, 819, 820, 821, 822, 823, 824, 825, 826, 827, 828, 829, 830, 831, 832, 833, 834, 835, 836, 837, 838, 839, 840, 841, 842, 843, 844, 845, 846, 847, 848, 849, 850, 851, 852, 853, 854, 855, 856, 857, 858, 859, 860, 861, 862, 863, 864, 865, 866, 867, 868, 869, 870, 871, 872, 873, 874, 875, 876, 877, 878, 879, 880, 881, 882, 883, 884, 885, 886, 887, 888, 889, 890, 891, 892, 893, 894, 895, 896, 897, 898, 899, 900, 901, 902, 903, 904, 905, 906, 907, 908, 909, 910, 911, 912, 913, 914, 915, 916, 917, 918, 919, 920, 921, 922, 923, 924, 925, 926, 927, 928, 929, 930, 931, 932, 933, 934, 935, 936, 937, 938, 939, 940, 941, 942, 943, 944, 945, 946, 947, 948, 949, 950, 951, 952, 953, 954, 955, 956, 957, 958, 959, 960, 961, 962, 963, 964, 965, 966, 967, 968, 969, 970, 971, 972, 973, 974, 975, 976, 977, 978, 979, 980, 981, 982, 983, 984, 985, 986, 987, 988, 989, 990, 991, 992, 993, 994, 995, 996, 997, 998, 999, 1000

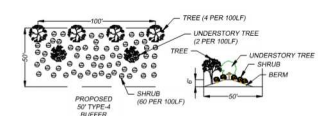

- GENERAL PROVISIONS:
1. DEVELOPMENT OF THE SITE SHALL BE GOVERNED BY THIS PLANNED UNIT DEVELOPMENT PLAN, DEVELOPMENT STANDARDS AND THE APPLICABLE PROVISIONS OF THE CITY OF MONROE UNIFIED DEVELOPMENT ORDINANCE (UDO).
 2. THE SCHEMATIC DEPICTIONS OF THE USES, PARKING AREAS, SIDEWALKS, STRUCTURES AND BUILDINGS, AND OTHER SITE ELEMENTS SET FORTH ON THE ZONING SITE PLAN ARE GRAPHIC REPRESENTATIONS OF THE DEVELOPMENT AND SITE ELEMENTS PROPOSED AND MAY BE ALTERED SUBJECT TO APPROVAL BY THE ZONING ADMINISTRATOR.
 3. ZONING IS TO BE CHANGED FROM RLD (MONROE) & RA-40(COUNTY) TO PUD "EAGLES REST AT LAKE LEE".
 4. A 2' EASEMENT FOR SIDEWALK MAINTENANCE WILL BE PROVIDED ALONG WHITE STORE RD., HWY 601 & MARION LEE ROADS.

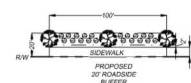

PRELIMINARY
NOT FOR
CONSTRUCTION

EAGLES REST AT LAKE LEE
MONROE, NC
PROVERBS 24:27, LLC,
231 POST OFFICE DRIVE
INDIAN TRAIL, NC 28079

OVERALL REZONING PLAN
DESIGNED BY: AEL
DRAWN BY: BLD
CHECKED BY: JCK
DATE: 02/27/23
AS SHOWN

Sheet
RZP-1